

QUESTIONS OR CONCERNS CONTACT CANARM AT:
 1-800-265-1833 (English) / 1-800-567-2513 (French)
 Monday through Friday 8:00 AM to 5:00 PM E.S.T.

TOOLS AND MATERIALS REQUIRED:



Wire Cutters



Star-headed Screwdriver



Wrench

Wiring supplies as required by the Canadian Electrical Code and/or the Quebec Electrical code

"INSTRUCTIONS PERTAINING TO RISK OF FIRE OR INJURY TO PERSONS"
"READ ALL INSTRUCTIONS"

"IMPORTANT SAFETY INSTRUCTIONS"

"SAVE THESE INSTRUCTIONS"

SAFETY PRECAUTIONS:

1. **TURN OFF ELECTRICAL POWER BEFORE STARTING INSTALLATION OF LIGHT FIXTURE.**
2. **THIS PRODUCT MUST BE INSTALLED IN ACCORDANCE WITH THE APPLICABLE INSTALLATION CODE BY A PERSON FAMILIAR WITH THE CONSTRUCTION AND OPERATION OF THE PRODUCT AND THE HAZARDS INVOLVED.**
3. **CONNECT THE GROUND WIRES (BARE COPPER OR GREEN) FROM YOUR FIXTURE TO THE GROUND WIRE (BARE COPPER OR GREEN) OR GROUND SCREW IN THE ELECTRICAL OUTLET BOX.**
4. **CLEAN GLASS WITH WATER ONLY.**

INSTALLATION: *Product May Not Look Exactly As Shown In Figures.

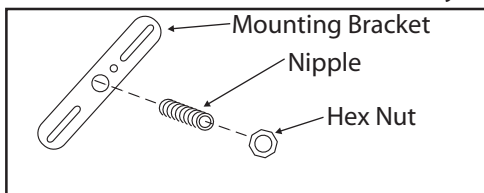

1. Attach nipple to mounting bracket. Adjust so it will clear hole in back of fixture and then lock nipple in place with hex nut.

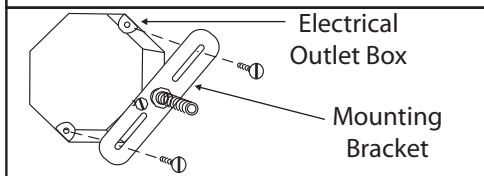

2. Attach mounting bracket to electrical outlet box with electrical box screws (not included).

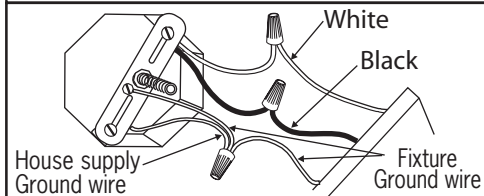

3. Connect the ground wires (bare copper or green) from your fixture to the ground wire (bare copper or green) or ground screw in the electrical outlet box. Connect electrical wires of fixture to wires in electrical box by marretting white wire to white wire, then black wire to black wire. Once connections of wires are completed, carefully tuck wires and wire nuts into the outlet box making sure no bare wire (on the black and white) is visible at the wire nuts.

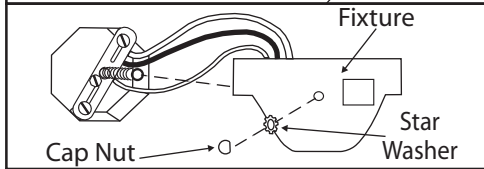

4. Tuck electrical wires into electrical box. Position hole in fixture over nipple and secure in place with star washer and cap nut.

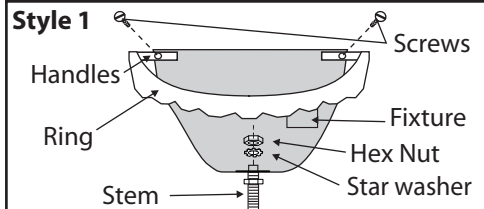

5. Style 1: May not be applicable to some models. Secure the ring (handles) to the back plate with screws provided.

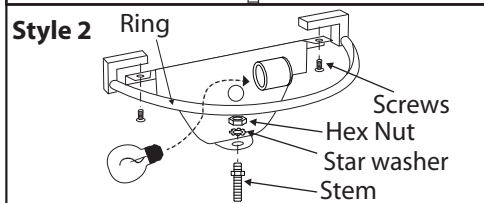

Style 2: Secure the ring to the back plate with screws provided. Install the stem to the fixture by hex nut and star washer.

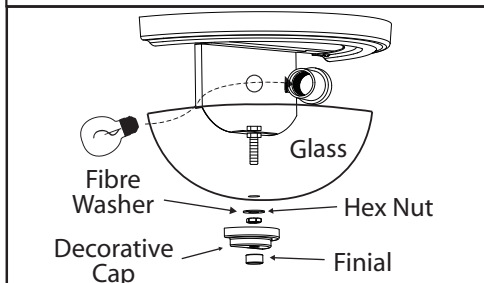

6. Install proper bulb type and wattage(not included).

7. Adjust the nipple until it will pass through the glass and cap, then secure in place with fibre washer and hex nut (only available for some models). Position the glass shade and hold in place with fibre washer, hex nut, decorative cap and finial.